

# CELEBRETTO®

## LINEAR TRACK

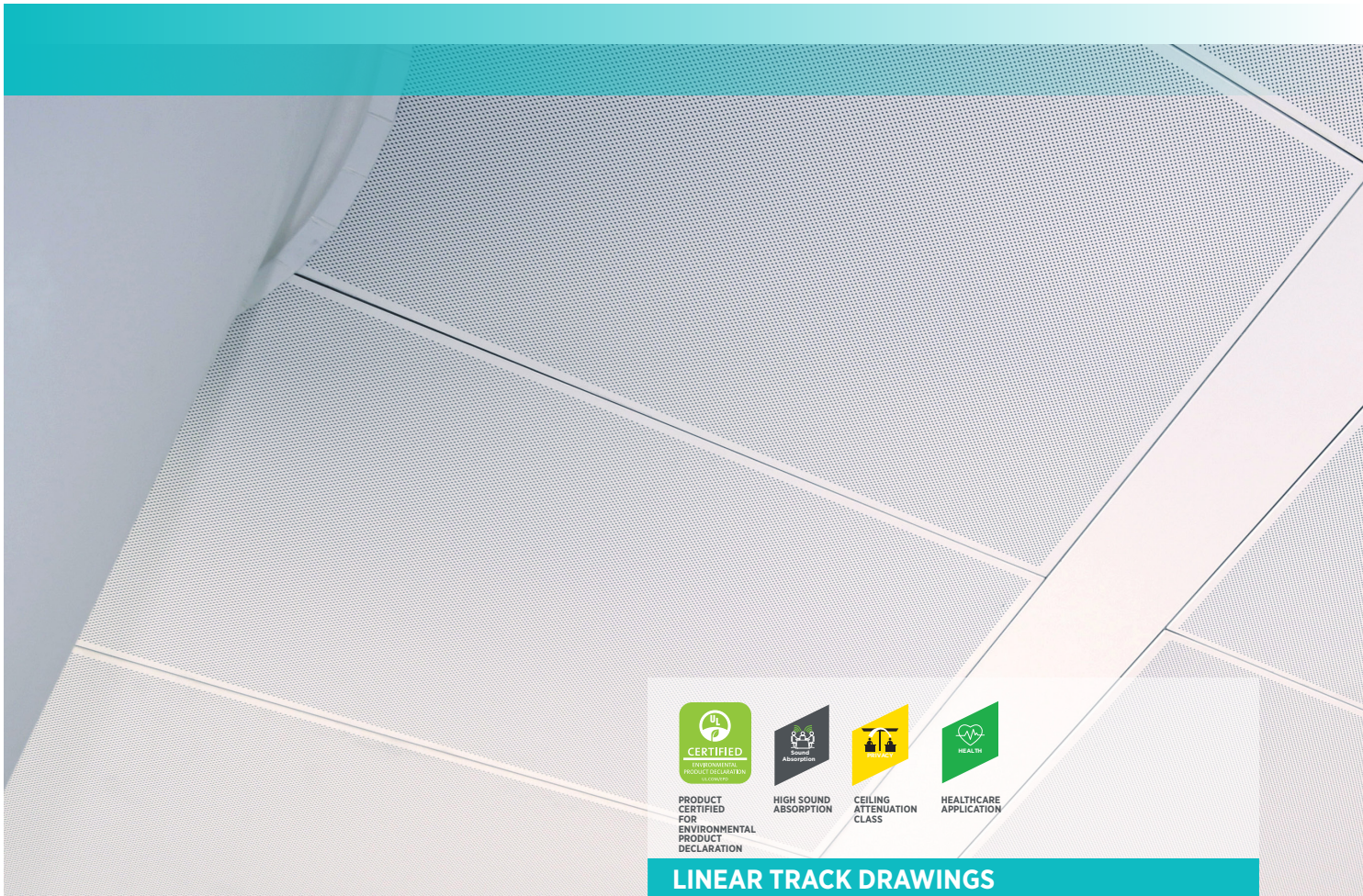

### LINEAR TRACK DRAWINGS

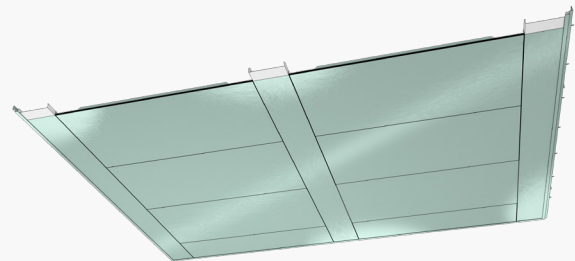

## FEATURES AND BENEFITS

- Modular design, configurable options.
- Linear track channels can be aligned with partitions.
- Linear track channel width is adjustable from narrow to wide.
- All panels are demountable without special tools, allowing easy access to the plenum.
- Easy service integration.
- Certificated for Environmental Product Declaration (EPD) as per ISO 14025.

## APPLICATIONS

- Large office spaces
- Train stations
- Universities
- Airports
- Executive offices

### AVAILABLE FINISHES



Explore our complete range of options in **CELEBRETTO® Colors, Finishes and Perforations Pattern** catalogue for detailed insights.

### SOUND ABSORPTION

Frequency, Hz	125	250	500	1000	2000	4000	NRC*
A1 Pattern** with Acoustic Fleece	0.70	<b>0.95</b>	<b>0.75</b>	<b>0.75</b>	<b>0.80</b>	0.80	<b>0.75</b>
A1 Pattern** with Infill***	0.70	<b>0.90</b>	<b>1.0</b>	<b>1.0</b>	<b>1.0</b>	1.0	<b>1.0</b>

\* Calculated to ASTM C 423-01

\*\* A1 Pattern: Diagonal Pattern. Hole Size Dia: 1.8mm, Open Area: 20%

\*\*\* Infill: Acoustic Fleece and 30mm Soft Fiber with Aluminium Foil





## LINEAR TRACK SYSTEM DRAWINGS

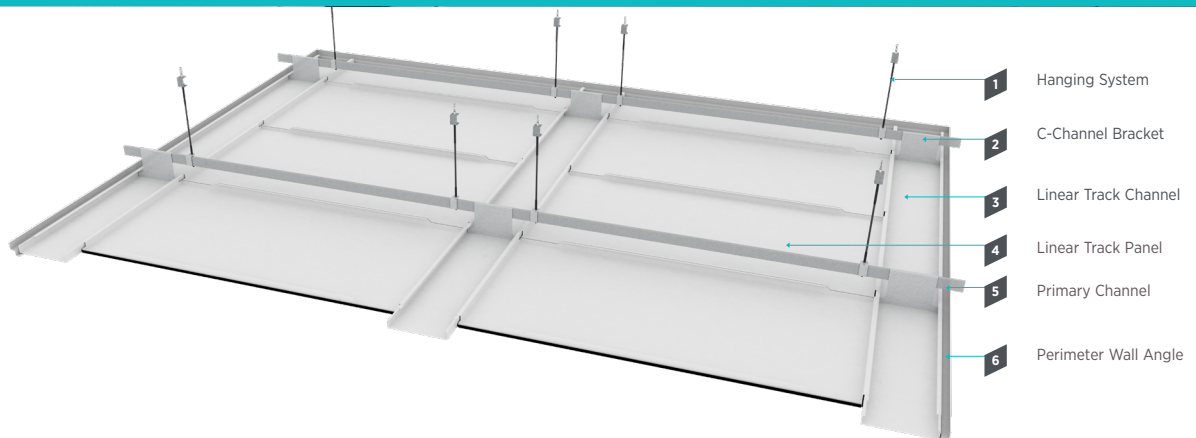





# SYSTEM COMPONENTS

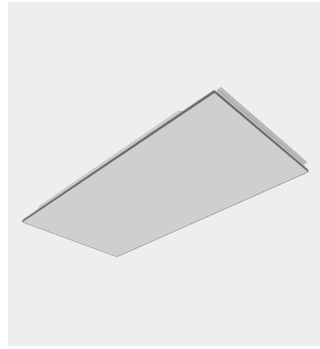

Linear Track Panel

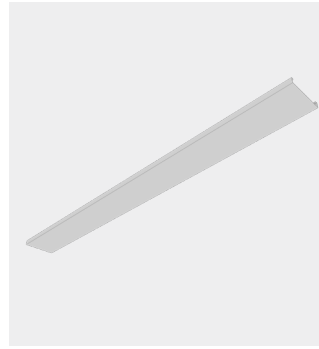

Linear Track Channel

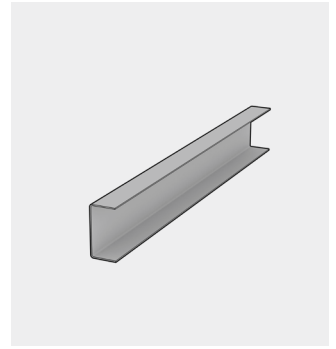

Primary Channel

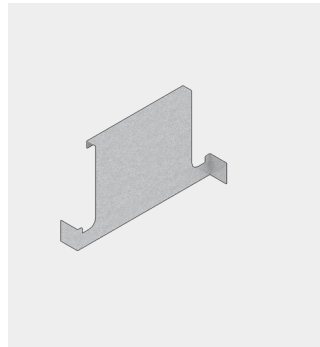

C-Channel Bracket



Hanging System

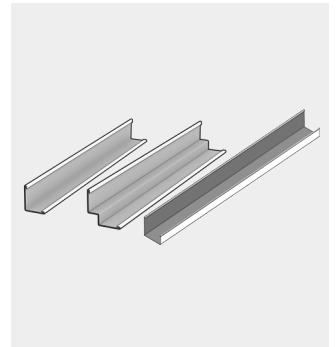

Perimeter Wall Angle  
Options

## Material Classification

Type C,  
Form C1, C2,  
Pattern A, B, C, G

## Thickness

Powder coat finish: 0.6mm – 1.4mm  
Wooden finish: 0.6mm

## Panel Height

30mm to 50mm

## Linear Track Width

100mm/150mm/200mm/250mm/300mm

## Panel Width

200mm to 600mm

## Panel Length

Up to 2400mm

## Edge (optional)

3mm black gasket

## Light Reflectance Coefficient [LR]

Based on the finish color and perforation pattern,  
LR up to 0.82

## Color

Standard: RAL 9016, RAL9006 and RAL9010.  
Other RAL colors are available upon request.  
Wooden patterns are available upon request

## Surface Burning Characteristics per ASTM E 84

Class A

## Additional Information

- Thickness depends on panel sizes and project requirements
- Consult USG Middle East technical team for other panel sizes



# SYSTEM SPECIFICATION

## LINEAR TRACK CEILING ACOUSTICAL PERFORMANCE

USG Middle East supplies metal ceiling panels with a range of acoustical performance to meet the needs of all kinds of projects. Various sound-absorbing backing options are available with performance up to 1.0 NRC and 34dB CAC. Consult with the USG Middle East technical team for further guidance.

PATTERN	OPEN AREA%	CELEBRETTO® METAL CEILING INFILL OPTIONS	CAC	NRC
A1	20%	Acoustic fleece	-	0.75
A1	20%	19mm Soft Fiber infill	-	0.90
A1	20%	15mm Mineral Fiber infill	32	-
A1	20%	Acoustic fleece with 30mm Stonewool & 19mm Mineral Fiber infill	32	0.90
A1	20%	Acoustic fleece with 25mm Glasswool & 12mm Gypsum infill	30	0.85
A1	20%	Acoustic fleece with 30mm Stonewool & Aluminum Foil	34	1.00
B2	16%	Acoustic fleece	-	0.60
15D	22%	Acoustic fleece	-	0.60
15D	22%	Acoustic fleece with 30mm Stonewool & Aluminum Foil	30	0.80
15E	11%	Acoustic fleece	-	0.65
15E	11%	Celebretto Metal Ceiling with acoustic fleece and 30mm Stonewool & Aluminum Foil	27	0.80
7E	1%	Celebretto Metal Ceiling with acoustic fleece	-	0.65
7E	1%	Celebretto Metal Ceiling with acoustic fleece and 30mm Stonewool & Aluminum Foil	26	0.90

- A1 Pattern: Diagonal Pattern, Hole Size Dia 1.8mm
- B2 Pattern: Even Pattern, Hole Size Dia 2.5mm
- 15D Pattern: Diagonal Pattern, Hole Size Dia 1.5mm

- 15E Pattern: Even Pattern, Hole Size Dia 1.5mm
- 7E Pattern: Even Pattern, Hole Size Dia 0.75mm

## INFILL OPTIONS\*

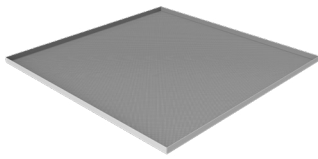
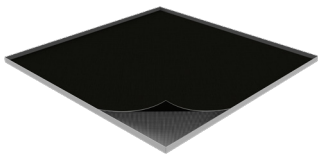
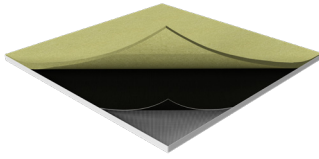
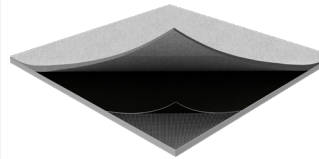
Plain	Acoustic Fleece	Acoustic Fleece and Soft Fiber	Acoustic Fleece and Mineral Fiber
			

\* Additional backer options available for NRC and CAC enhanced total acoustical performance

## ITEM CODIFICATION

### Linear Track Panel

A: Aluminium  
 S: Steel  
 SS: Stainless Steel  
 LTP: Linear Track Panel  
 A1: Perforated A1 Pattern  
 600: Panel Width  
 1200: Panel Length  
 T0: Material Thickness (1.0mm Thickness)  
 R10: RAL 9010 Powder Coated Finish  
 G: with Gaskets

**ALTPA1-600120010R10-G**

### Linear Track Channel

S: Steel  
 A: Aluminium  
 SS: Stainless Steel  
 LTC: Linear Track Channel  
 200: Channel Width  
 T3: Material Thickness (1.3mm Thickness)  
 R10: RAL 9010 Powder Coated Finish

**SLTC-20013R10**