

CELEBRETTO®

PARALINE BAFFLES

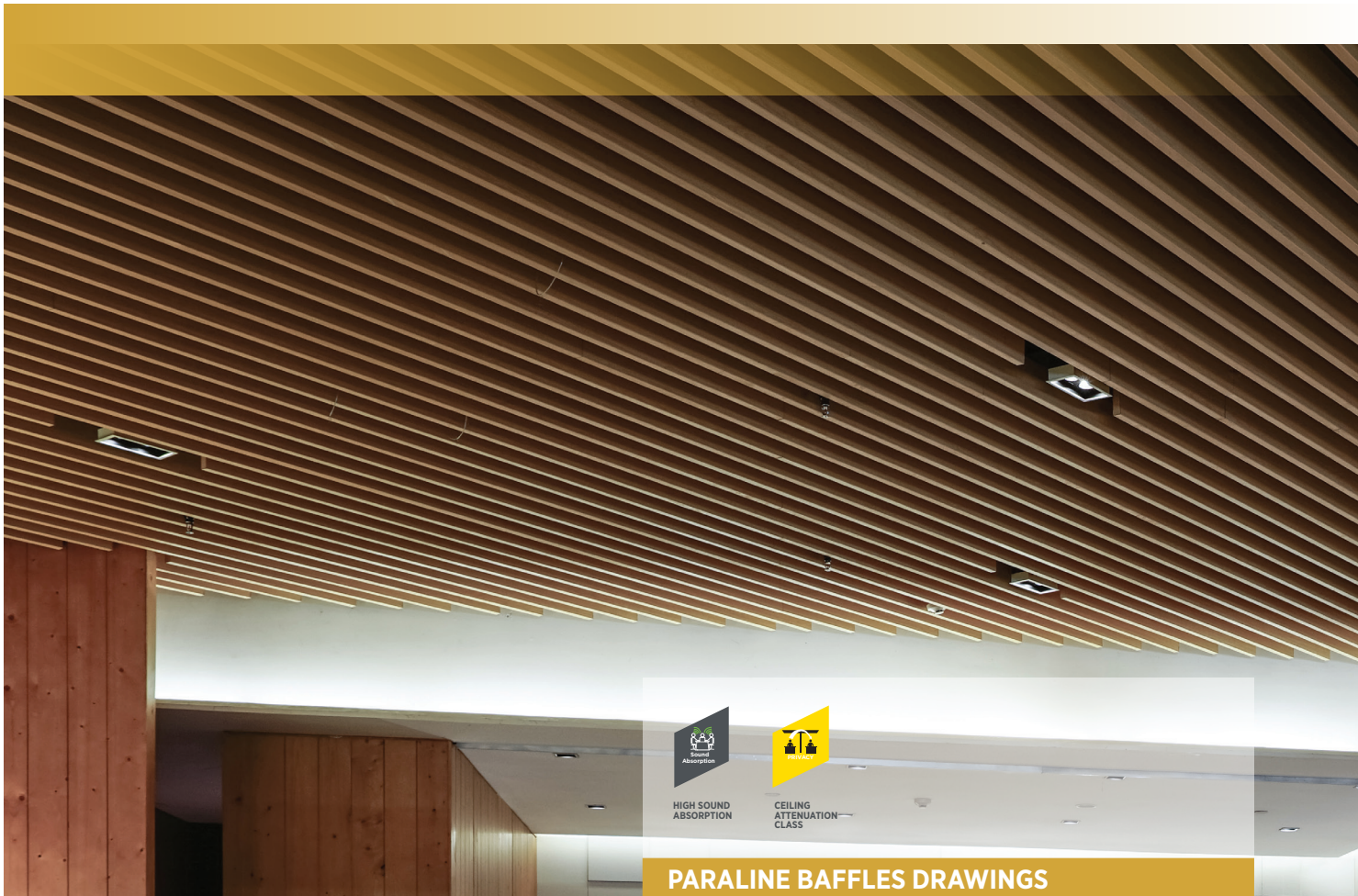

HIGH SOUND
ABSORPTION



CEILING
ATTENUATION
CLASS

PARALINE BAFFLES DRAWINGS



AVAILABLE COLOR



Explore our complete range of options in **CELEBRETTO® Colors, Finishes and Perforations Pattern** catalogue for detailed insights.

FEATURES AND BENEFITS

- Paraline baffles are metal baffles with easy access to an enclosed plenum.
- Available in various system sizes with different baffles, dimensions, and finishes per a project's requirements.
- A unique modern look that fits any interior design concept.
- Available with an optional closing strip.
- Available in plain and perforated patterns for acoustic performance.
- Unique design - metal baffle integrated with linear strip ceiling to improve the space's look and acoustic performance.
- It can be installed directly onto the existing ceiling or with a hanging suspension system.

APPLICATIONS

- Entertainment
- Lobbies
- Restaurants
- Offices
- Transportation

SOUND ABSORPTION

Frequency, Hz	125	250	500	1000	2000	4000	NRC*
A1 Pattern Fully Perforated**	0.25	0.50	1.0	1.0	1.0	1.0	0.85

* Calculated to ASTM C 423-01

** Acoustic Fleece and 38mm Soft Fiber Infill

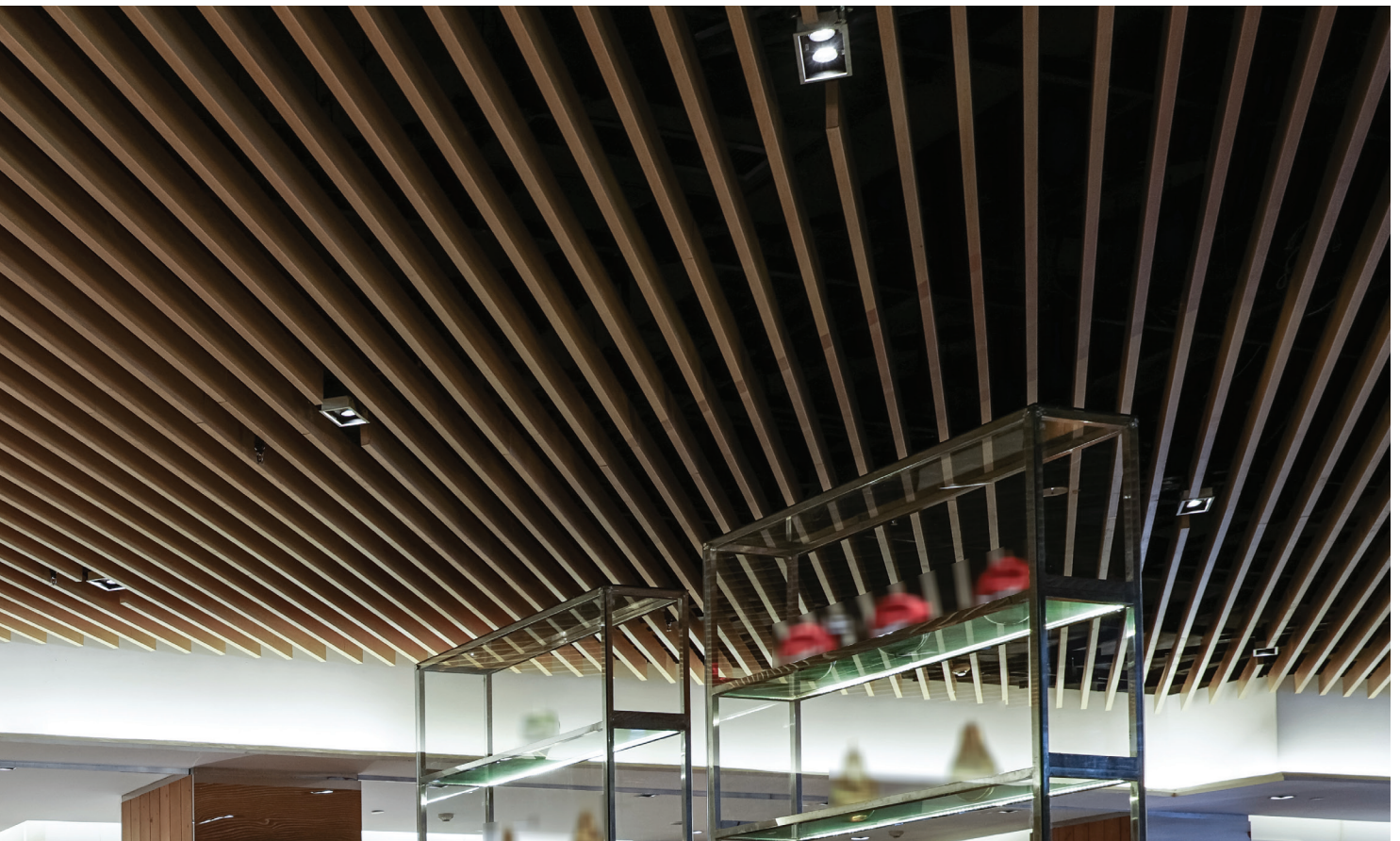

PARALINE BAFFLES SYSTEM DRAWINGS

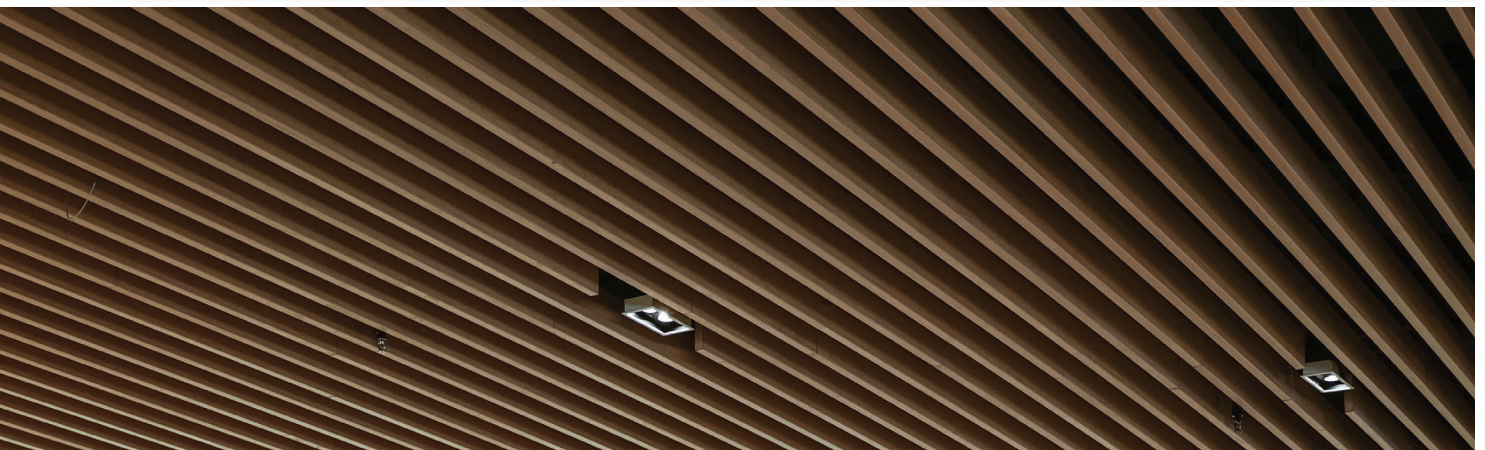
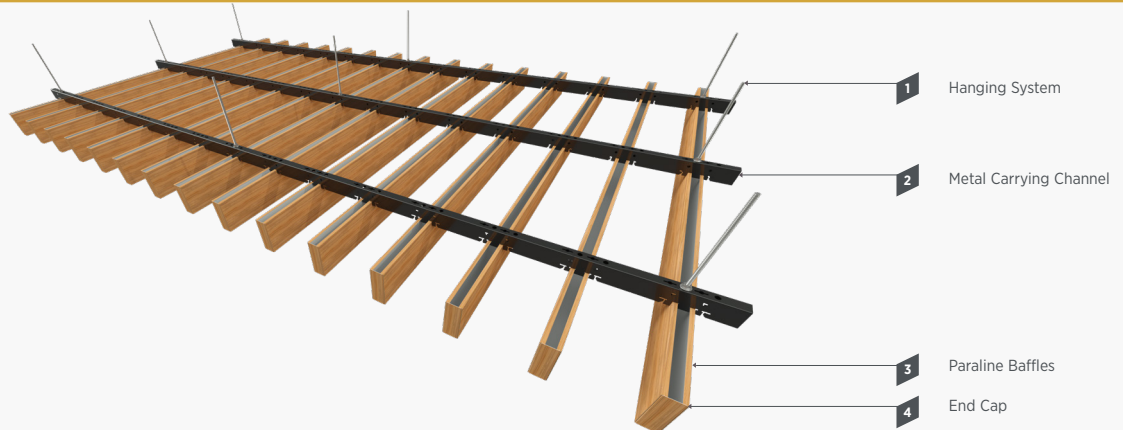



SYSTEM COMPONENTS



Paraline Baffle & End Cap



Carrying Channel

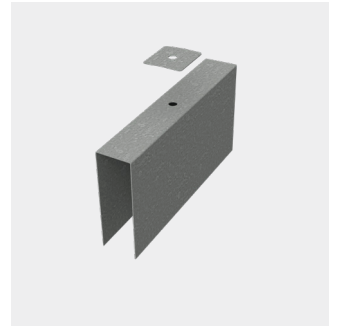

Connecting Splices & Tightening Piece

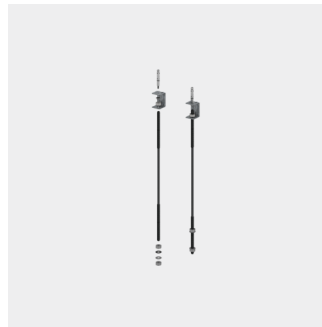

Hanging System

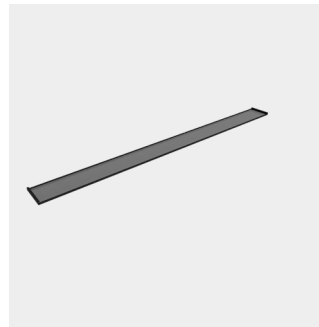

Closing Strip (Baffle with closing strip option)

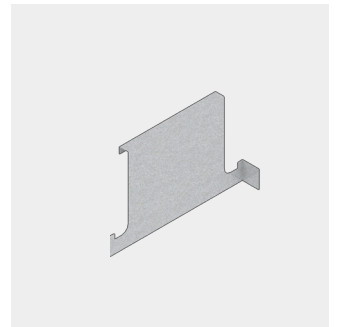

C-Channel Bracket (Baffle with closing strip option)

Material Classification

Type C,
Form C1, C2,
Pattern A, B, C, G

Thickness

Powder coat finish: 0.6mm–1.4mm
Wooden finish: 0.6mm

Baffle Width

30mm, 40mm, 50mm, 80mm, 100mm, 150mm

Baffle Height

50mm, 80mm, 100mm, 150mm, 200mm

Baffle Length

Up to 2400mm Baffle Spacing (clear gap) Min
30mm

Light Reflectance Coefficient [LR]

Based on the finish color and perforation
pattern, LR up to 0.82

Color

Standard colors are RAL 9016, RAL 9006 and
RAL 9010. Other RAL colors are available upon
request

Surface Burning Characteristics per ASTM E 84 Class A

Additional Information

- Recommended spacing is to be equal to the height of the baffle
- Thickness depends on panel sizes and project requirements
- Consult USG Middle East technical team for other panel widths



PARALINE BAFFLE WITH
CLOSING STRIP

SYSTEM SPECIFICATION



PARALINE BAFFLE METAL CEILING ACOUSTICAL PERFORMANCE

USG Middle East supplies metal ceiling panels with a range of acoustical performance to meet the needs of all kinds of projects. A variety of sound-absorbing backing options are available. Consult with the USG Middle East technical team for further guidance.

PATTERN	OPEN AREA%	CELEBRETTO® METAL CEILING INFILL OPTIONS	CAC	NRC
A1	20%	Paraline Baffles with 38mm Soft Fiber infill	-	0.85

• A1 Pattern: Diagonal Pattern, Hole Size Dia 1.8mm

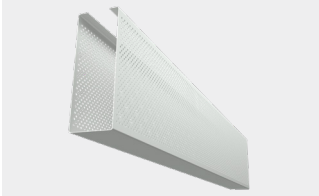
INFILL OPTIONS*

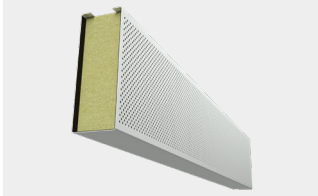
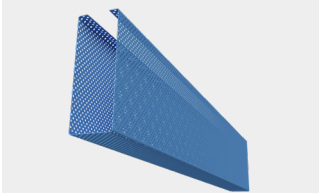
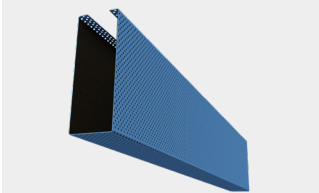
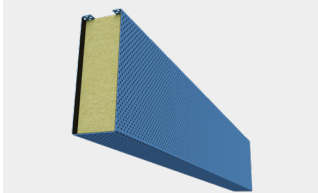
	Without Infill	With Acoustic Fleece	With Acoustic Fleece and Infill
STANDARD WITH PLAIN BORDER			
OPTIONAL FULLY PERFORATED			

* Additional backer options available for NRC and CAC enhanced total acoustical performance

ITEM CODIFICATION

Paraline Baffles

S: Steel
 A: Aluminium
 PB: Paraline Baffle
 PA1: Perforated A1 Pattern
 30: Baffle Width
 100: Baffle Height
 7: Material Thickness (0.7mm Thickness)
 R16: RAL 9016
 SF25: Soft Fiber Infill 25mm Thickness

SPBA1-301007R16-SF25

Carrying Channel

CC: Carrying Channel
 30: Carrying Channel Width
 120: Clear Gap Between Carrying Channel
 6: Material Thickness (0.6mm thickness)
 R05: RAL 9005 Powder Coating

CC301206R05